

I.C.P. Srl	SERVICE BULLETIN	03-2005	Issued on 18/07/05	Page 1 of 2
-------------------	-------------------------	----------------	--------------------	-------------

REV. 00	del: 18/07/05
---------	---------------

CLASSIFICATION: OPTIONAL

SUBJECT: mandatory control of the front strut attachment SA086 on the wing for Savannah™ and Bingo aircraft: opening of a small slot in order to ease the control of the plates SA086.

AIM: Verification of the condition of the attachment of the two semi-wings front strut (part SA086)

AIRCRAFT INVOLVED / PARTS INTERESTED:
Aircraft series Savannah™
Aircraft series Bingo

EXECUTION TERMS: opening of a small slot in order to ease the control of the plates SA086

Following the suggestion of the Norwegian Ultralight Aviation Authorities, in order to ease the inspection of the plates SA086 for the attachments between semi-wings and front struts, it is advisable to enlarge the already present slot on the semi-wing in correspondence of the outlet of the mentioned plate.

The opening must be performed as from enclosed drawing: the present slot must be prolonged by 15 mm, for a height of approximately 42 mm, which corresponds to leaving the sheet metal on the angle plate of the spar only (it is therefore not necessary to remove rivets from the spar).

The operation must be performed by making two bores having 10 mm in diameter in the A and B position; they will be useful to link the cuts on the sheet metal, to be performed solely with a parting tool or other cutting tool suitable for sheet metal. It will then be necessary to work the edges with a file in order to eliminate all burrs. Please note that hole A must be made very carefully because it is tangent to the angle piece of the lower floor of the main spar that must not be touched during the work.

Any damage (scratches, notches to the metal, etc..) to the angle piece of the lower floor or to the angle fixing piece of the SA086 plate is unacceptable.

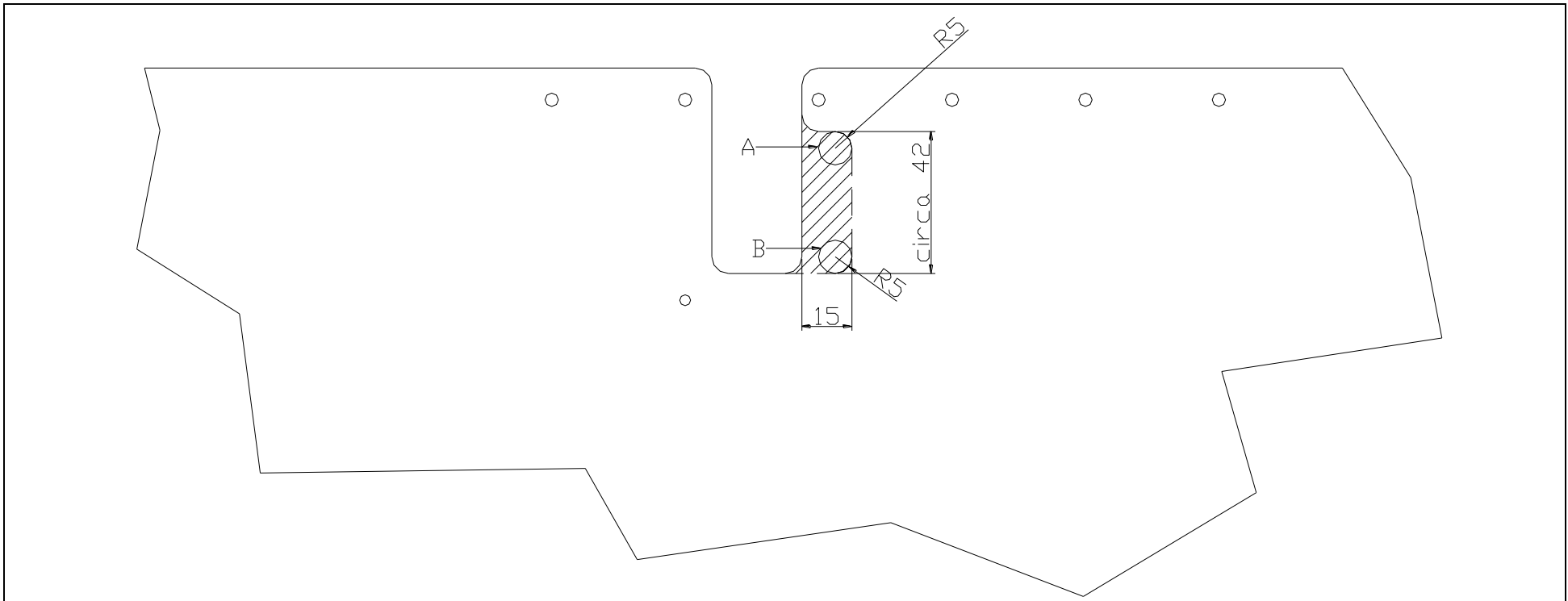

NECESSARY LABOUR: /

NECESSARY MATERIAL: /

SPECIAL TOOLS: /

WEIGHT AND CENTRING VARIATIONS:

REFERENCES: /

PUBLICATIONS INVOLVED: / SB 02-2005

EXECUTION INSTRUCTIONS: /